



TO LET

Herne Hill Road London, SE10

£1,750 pcm

Well Presented Spacious One
Bedroom Ground Floor Flat





Description

Hindwoods are delighted to offer this extremely spacious one bedroom ground floor flat with a courtyard to the rear.

The property has been refurbished throughout, to a great standard, with new kitchen and bathroom.

Situated along Herne Hill Road, the property enjoys a prime position within the sought-after Herne Hill area of south London. It offers excellent transport connections via its mainline station, providing swift access to key destinations such as Victoria, Blackfriars and beyond, making it ideal for commuters. Brockwell Park is just a short distance away, The area is well known for its vibrant yet relaxed atmosphere, with a range of independent cafés, restaurants and local shops centred around the station square.

The accommodation comprises

Entrance Hall

Reception

15' 4" x 11'6" (4.67m x 3.51m).

Double glazed windows to front, original picture rail, double radiator, freshly painted and new carpets.

Bedroom

15' 4" x 11'5" (4.67m x 3.48m).

Double glazed window to rear, Feature Fireplace, double radiator, freshly painted and new carpets.

Kitchen

13' 5" x 9'10" (4.09m x 3m).

Double glazed window to side, range of wall and base units to 2 walls, fridge freezer, build in over & hob, with extractor hood over, double radiator, vinyl flooring.

Bathroom

Double glazed window to rear, white suite comprising of low level WC, hand wash basin, with vanity under, panelled bath and separate shower. Part tiled walls, vinyl flooring.

Garden

Court yard area to rear.

Viewings

Strictly via Hindwoods.

Donna Distin

D.distin@hindwoods.co.uk



Herne Hill Road

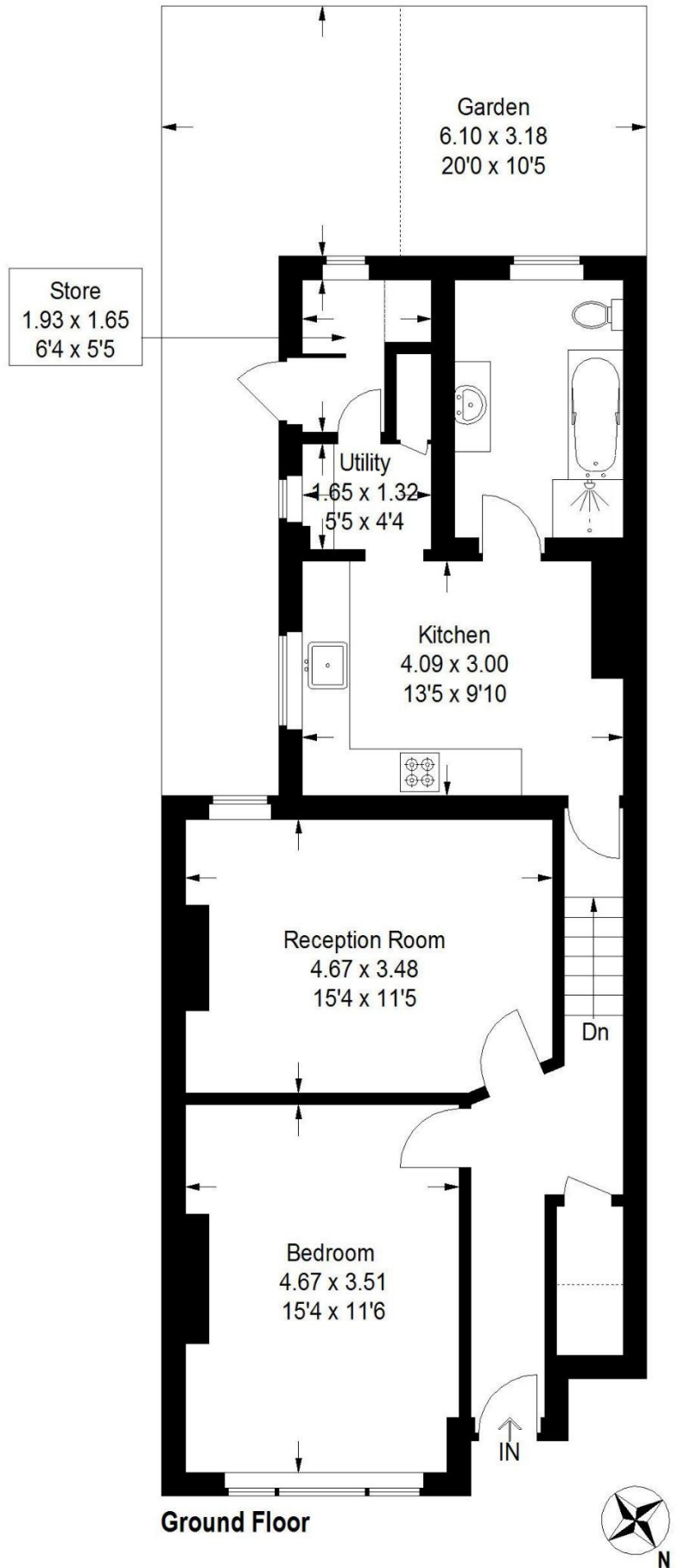

 = Reduced headroom below 1.5 m / 5'0

Approximate Gross Internal Area
73.0 sq m / 786 sq ft

Illustration for identification purposes only,
measurements are approximate.