

TO LET

**Brighton House  
Camberwell Green  
London, SE5**

**£1,750 pcm**

2 Bedroom First Floor Flat -  
Unfurnished







## Description

Hindwoods are delighted to offer to the market this well presented spacious two bedroom first floor flat.

Ideally located, overlooking Camberwell Green and close to shopping facilities with excellent bus routes and within a mile of Denmark Hill Station. Available immediately.

The accommodation comprises: -

### Entrance Hall

Radiator. Entry phone.

### Lounge

11'8" x 15'9" (3.57m x 4.79m)

Three sash windows. Radiator. Picture rail. Feature fire surround. Fitted carpet.

### Bedroom 1

12'2" x 15'9" (3.70m x 4.80m)

Sash window. Radiator. Built in cupboard. Feature fire surround. Fitted carpet.

### Bathroom

6'8" x 5'5" (2.03m x 1.65m)

White bathroom suite comprising WC, pedestal sink, bath with shower mixer and rail. Heated towel rail. Vinyl flooring.

### Bedroom 2

7'3" x 11'8" (2.20m x 3.56m)

Sash window. Radiator. Fitted carpet. Feature fire surround.

### Kitchen

10'1" x 14'4" (3.08m x 4.37m)

Range of wall and base units with black work surface with inset stainless steel sink. Built in electric oven with gas hob and extractor hood. Tiled splashback. Washing machine. Fridge Freezer. Built in cupboard housing boiler. Sash window. Radiator. Vinyl flooring.



## Viewings

Strictly via Hindwoods.

Donna Distin

[D.distin@hindwoods.co.uk](mailto:D.distin@hindwoods.co.uk)

Energy Efficiency Rating		
	Current	Potential
Very energy efficient - lower running costs		
(92 plus) <b>A</b>		
(81 - 91) <b>B</b>		
(69 - 80) <b>C</b>		
(55 - 68) <b>D</b>	69	70
(39 - 54) <b>E</b>		
(21 - 38) <b>F</b>		
(1 - 20) <b>G</b>		
Not energy efficient - higher running costs		
England & Wales	EU Directive 2002/91/EC	

## 4 Brighton House

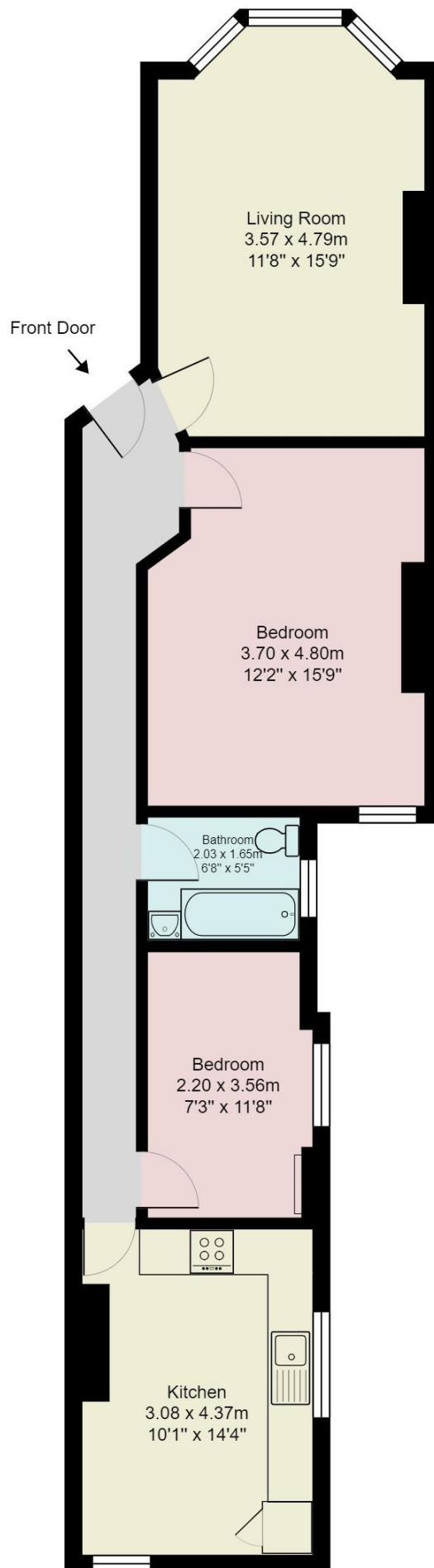

Gross Internal Area: 63.2 m<sup>2</sup> ... 681 ft<sup>2</sup>

All measurements are approximate and for display purposes only.